

FOR SALE

TWO-STORY INDUSTRIAL OFFICE/WAREHOUSE CONDOMINIUM

SCOTTSDALE AIRPARK SUBMARKET | MCDOWELL MOUNTAIN BUSINESS PARK

±3,748 SF



16412 N 92ND STREET | SUITE D130 | SCOTTSDALE, ARIZONA 85260

TO SCHEDULE A TOUR OR FOR MORE INFORMATION PLEASE CONTACT:



Randy Shell
Designated Broker
C 480.694.4100
randy@shellcommercial.com



Amanda Wright
Senior Associate
C 480.236.0037
amanda@shellcommercial.com

Office Phone:
480.443.3992
shellcommercial.com



SHELL
Commercial Investment Real Estate

16410 N 91st St | Suite 112
Scottsdale, AZ 85260

FEATURES

PRICE: \$1,480,000.00 (\$395/sf)

SIZE: ±3,748 sf two-story office/warehouse condominium

WAREHOUSE:

- Evap-cooled warehouse
- ±22' clear height ceilings
- Rubber mat flooring
- 12'x14' electric rollup door
- Two (2) storage rooms

FIRST FLOOR:

- Nice bright reception area with stacked stone feature wall
- Large Conference Room with sliding glass door
- Well-appointed kitchenette with sink, room for sub counter refrigerator and upper and lower cabinetry.
- Restroom
- Four (4) offices with open ceilings
- Open exposed ductwork throughout for modern feel

SECOND FLOOR:

- Three (3) private offices – two overlooking the warehouse
- Two (2) open work room spaces
- Large restroom featuring elegantly tiled shower with glass door
- Kitchenette featuring sink, room for full size refrigerator, upper and lower cabinetry and ample counter space for appliances.

PARKING: Five (5) Designated spaces

R.E. TAXES: \$3,959.10 (2023)

HOA: \$502/month

ZONING: I-1, PCD, Light Industrial, City of Scottsdale



FIRST FLOOR: ±2,544 SF
 SECOND FLOOR: ±1,204 SF
 TOTAL: ±3,748 SF

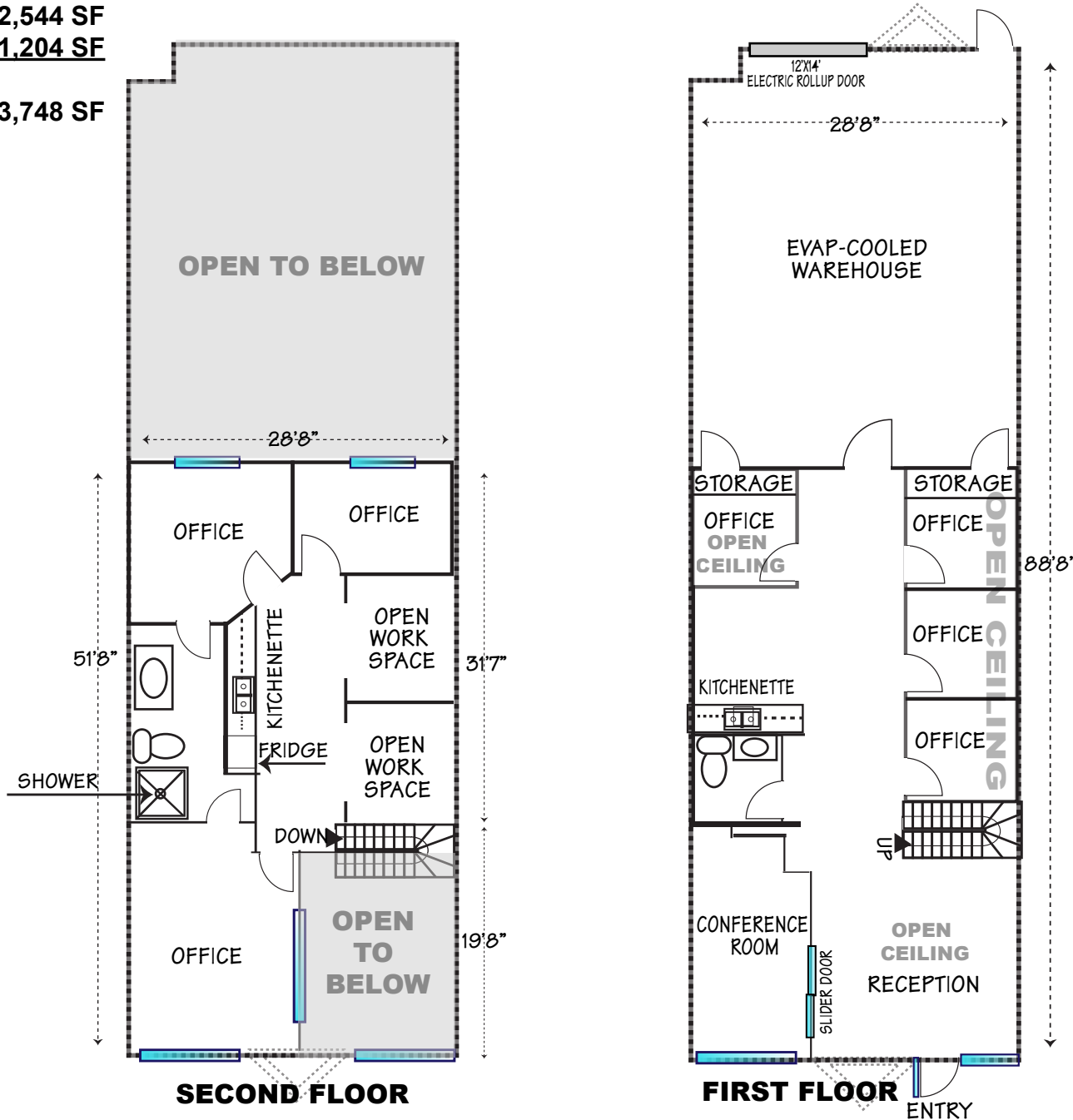

NOT TO SCALE All information furnished regarding property for sale, rental or financing is from sources deemed reliable, but no warranty or representation is made to the accuracy thereof and same is submitted to errors, omissions, change of price, rental or other conditions, prior to sale, lease or financing or withdrawal without notice. No liability of any kind is to be imposed on the broker herein. This information has been secured from sources deemed reliable, however, we make no warranties as to its accuracy.

